

PE300

Elliptical

# ASSEMBLY GUIDE

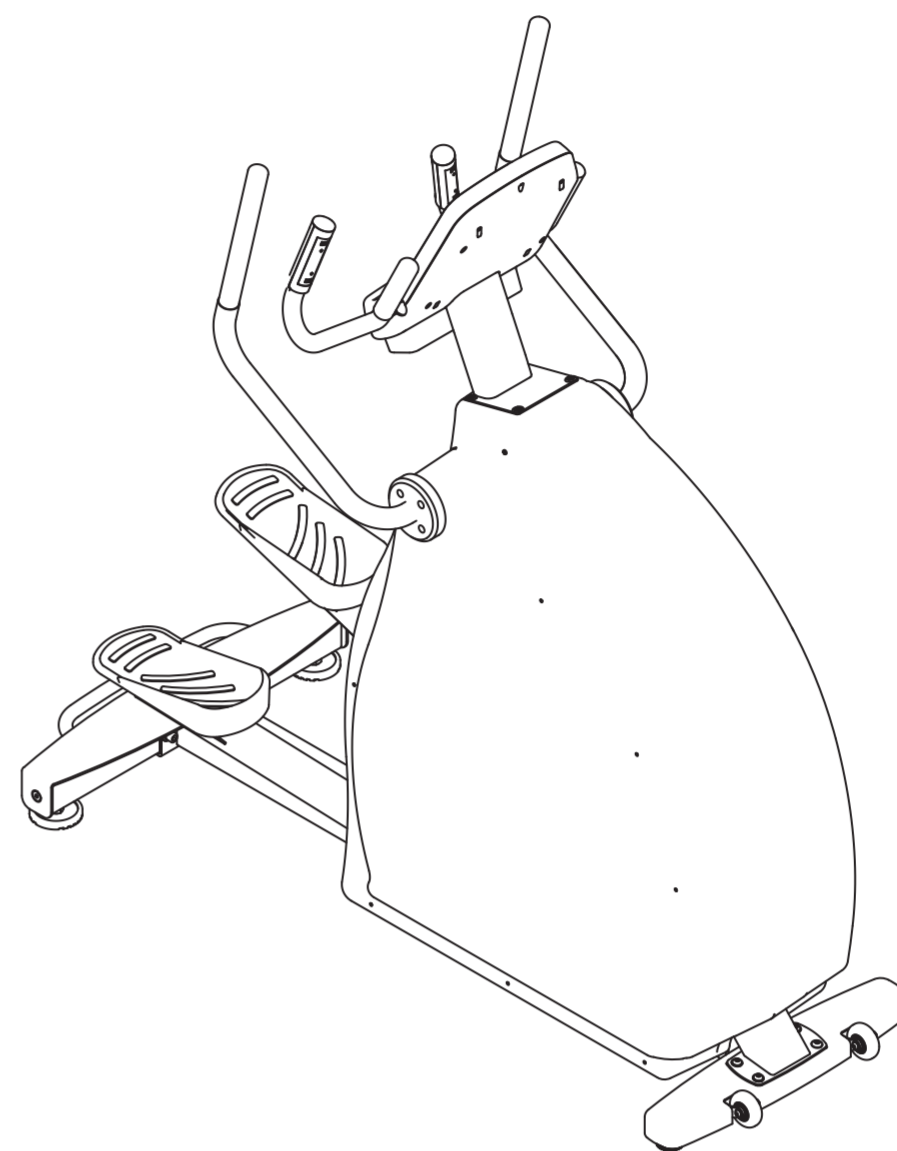

**! CAUTION**  
Read all precautions  
and instructions in this manual  
before using this equipment

Engineered and manufactured by Impulse® Fitness



## Subassembly Parts List

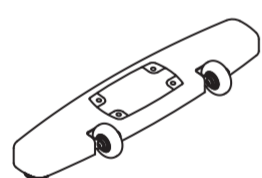

Front Base

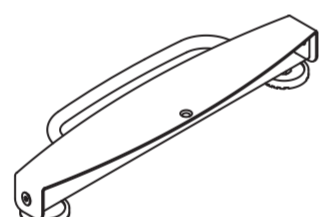

Back Pad Frame

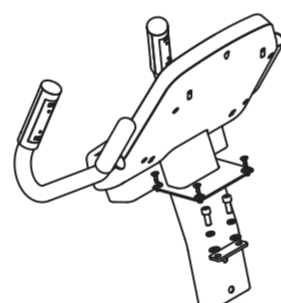

Console

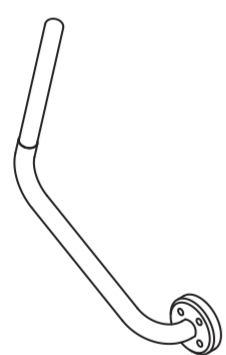

Right Handle

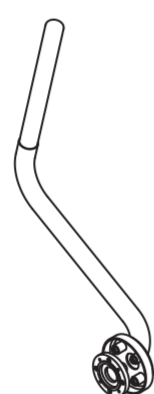

Left Handle

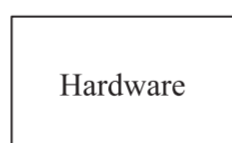

Hardware

Hardware

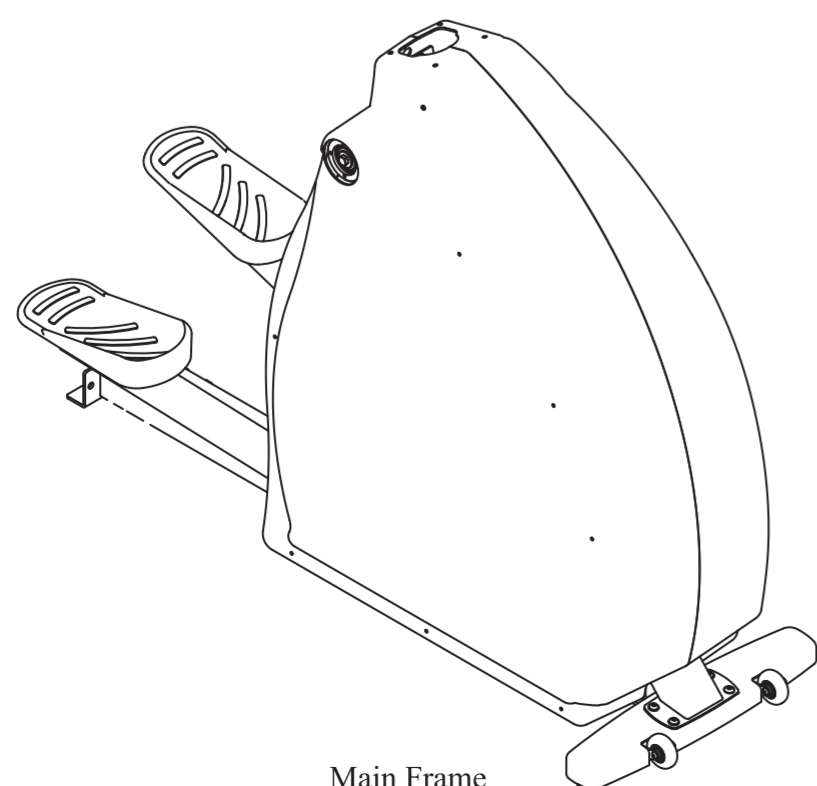

Main Frame

## Hardware List

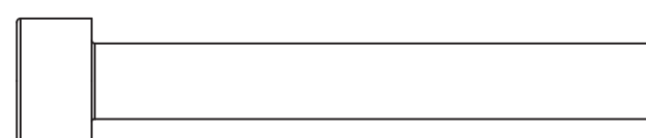

M10\*75\*35 Allen Bolt (1 PC)

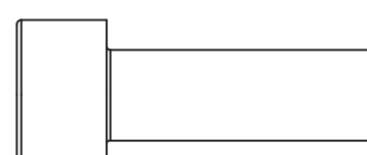

M10\*35 Allen Bolt (2 PCS)

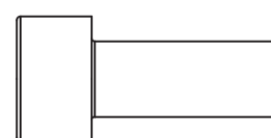

M10\*25 Allen Bolt (3 PCS)



M10\*22 Allen Bolt (2 PCS)

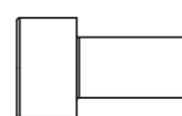

M8\*15 Allen Bolt (8 PCS)



Round Plug (2 PCS)

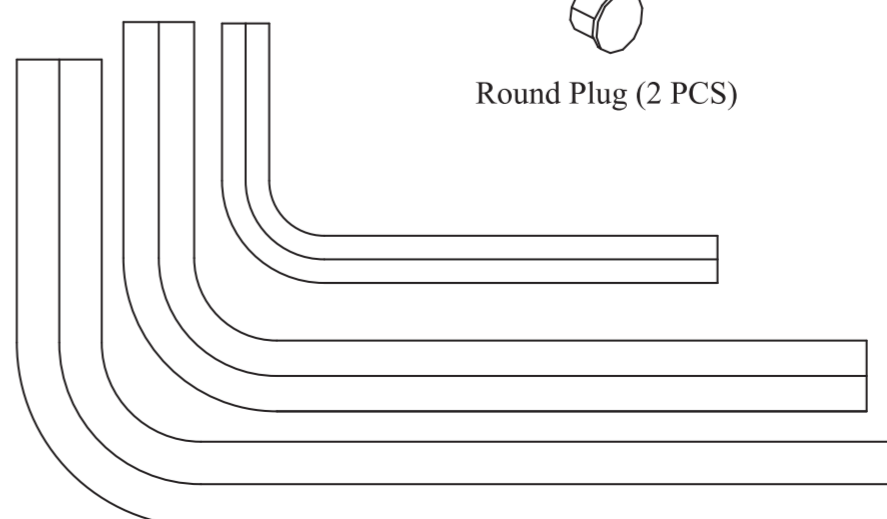

Allen Wrench S=6, 8, 10 (1 PC)

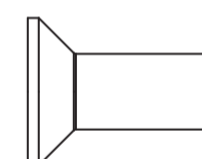

M10\*25 Allen Screw (1 PC)

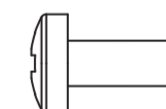

M6\*15 Phillip Screw (8 PCS)

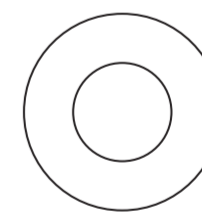

Φ13\*Φ26\*2 Washer (2 PCS)

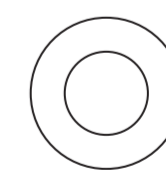

Φ11\*Φ20\*1.5 Washer (4 PCS)



Spring Washer Φ8 (8 PCS)



Spring Washer Φ10 (4 PCS)



Spring Washer Φ12 (4 PCS)

### Step 1

Install The Front Base (47#), The Back Pad Frame (6#), The Back Cover (10#):

1. Take down The Back Cover (10#);
2. Fixing The Back Pad Frame (6#) to The Main Frame (1#).

Using:

- 66# Allen Bolt M12\*22 (2PCS)
- 67# Allen Bolt M12\*35 (2PCS)
- 74# Spring Washe  $\Phi 12$  (4PCS)
- 80# Washer  $\Phi 13*\Phi 26*2$  (2PCS)

Adjust The Adjustive Cushion.

3. Fixing The Back Cover (10#) to The Back Pad Frame (6#).

Using:

- 57# Allen Screw M10\*25 (3PCS)

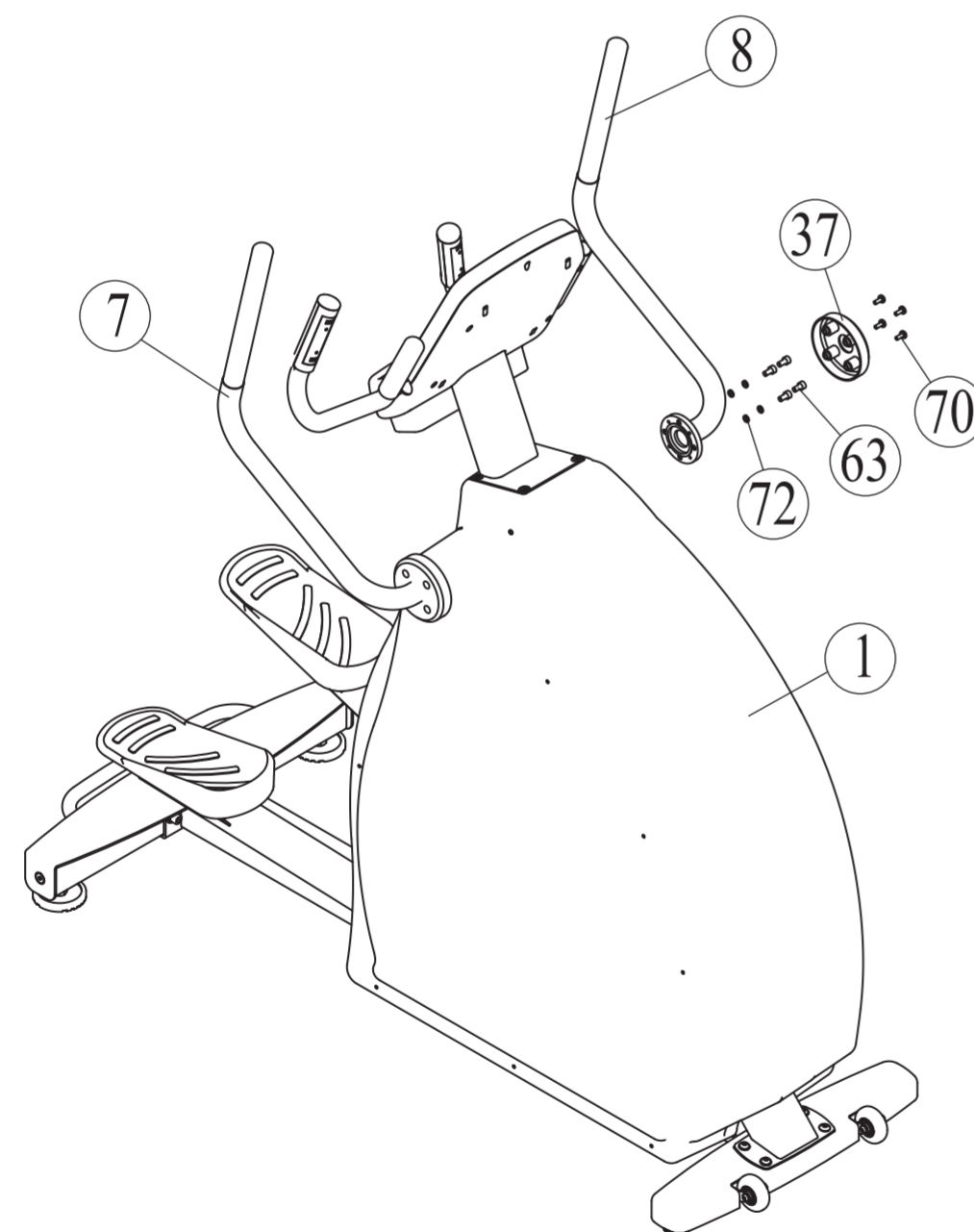
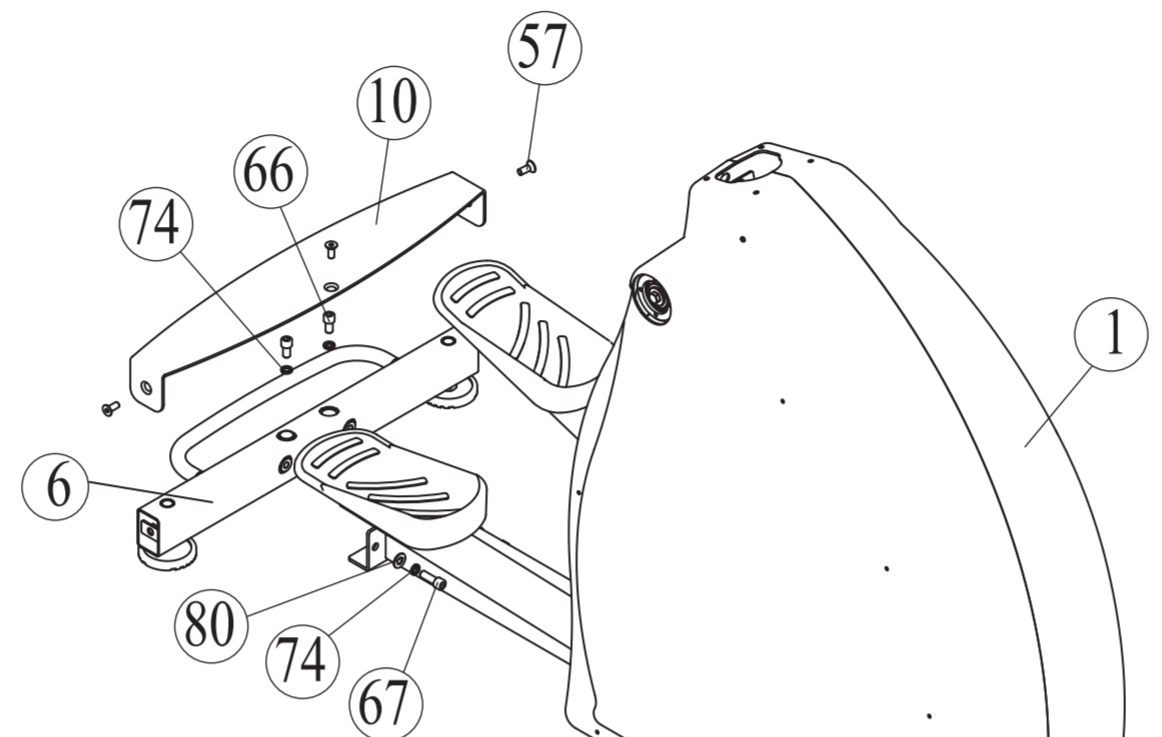

### Step 3

Install The Left Handle (8#), The Right Handle(7#):

1. Fixing The Left Handle (8#) And The Right Handle (7#) to The Main Frame (1#). Using:
  - 63# Allen Bolt M8\*15 (8PCS)
  - 72# Spring Washe  $\Phi 8$  (8PCS)
2. Fixing The Handle Upholstery (37#) to The Left Handle (8#) And The Right Handle (7#). Using:
  - 70# Phillip Screw M6\*15 (8PCS)

### Step 2

Install the Console(E12#):

1. Have your helper hold the Console (E12#). Plug Console Line 2 (E3#) and Console Line 1 (E8#).
2. Fixing The Console (E12#) to The Main Frame (1#). Using:
  - 64# Allen Bolt M10\*25 (3PCS)
  - 65# Allen Bolt M10\*75\*35 (1PC)
  - 73# Spring Washe  $\Phi 10$  (4PCS)
  - 78# Washer  $\Phi 11*\Phi 20*1.5$  (4PCS)
3. Fixing The Round Plug (40#) (2PCS) to The Main Frame (1#).
4. Fixing The Upholstery Part (11#) to The Main Frame (1#).

Using:

- 91# Rubber Fastener (4PCS)

